



Saarinen

Dining Tables

'Compromise comes from
a fear of being pure.'

Eero Saarinen



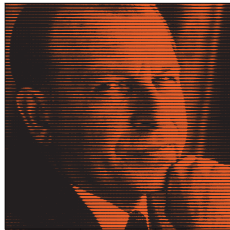

Eero Saarinen is a giant of 20th Century design and architecture, but it is the Tulip Tables designed for Knoll for which he is usually remembered.

The range is available in white laminate, wood veneer or a selection of marble finishes with a white or black Rilsan coated base.

The polyester coat on the marble prevents ensures that the marble remains pristine for many years, whilst the Rilsan coat on the cast aluminum bases is one of the most durable coatings available.

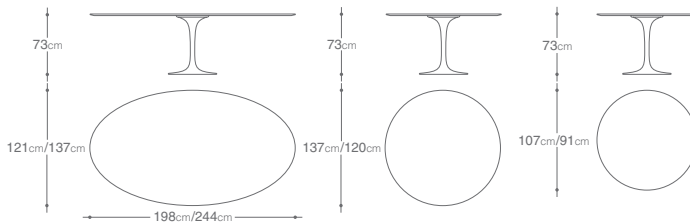

Heights vary slightly depending on finish

KnollStudio

www.knollint.com

Design and front photograph Damian Willett/Michael Kemp

